

Device for Emergency Water (D.E.W.)

Anne Alcasid, Corinne Clinch, Uriel Eisen, Elizabeth Ha, Yixing Shi, and Christina Yoon
 Dr. Conrad Zapanta and Dr. Theresa Dankovich



Problem and Clinical Need

- Consumption of unclean water is a direct threat to public health in areas with poor infrastructure
- Can cause dehydration, fever, and muscle aches, and death
- Approximately 3.4 million people die each year from a water related disease, and 780 million people worldwide lack access to clean water[1]
- Need a solution that provides safe, accessible drinking water for disaster relief and low-resource areas
- We intend to provide short-term clean water at a lower cost than current industrial products and offer a large-scale deployable solution

Innovation behind D.E.W.

- New filter paper called p[Ag]
- Embedded with silver nanoparticles
- Novel in its ease of use and low-cost production
- Eliminates both suspended particles and harmful microorganisms from contaminated water
- Easier to transport, distribute, and use in comparison to other current water purification techniques

Usability

Extensive usability studies were conducted during initial prototyping stages and for the final prototype:

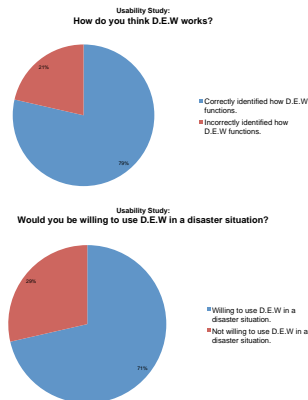

Figure 1: Results of usability studies after interviewing 14 individuals using the most recent iteration of the prototype

Description of Design

Our design is a uniquely shaped plastic bag with an incorporated filter and drinking straw. The device is used when the only sources of drinking water are biologically or physically contaminated.

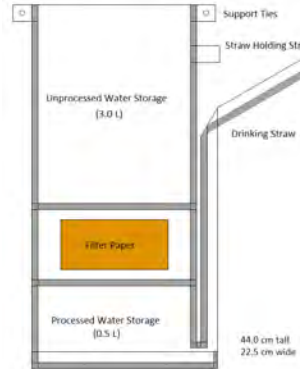

Figure 2: Proposed final design with all the parts of the prototype labeled

How to Use DEW

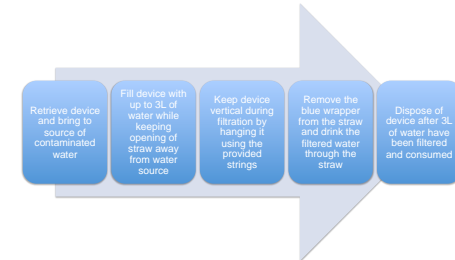

Figure 4: How a user would use D.E.W. in a disaster situation

Estimation of Product Costs

Our product is expected to cost less than \$2.10 per device. Below is a breakdown of our anticipated costs per unit when manufacturing in batches of 10,000 units.

| | |
|--|---------------|
| Total Material and Labor Cost | \$1.05 |
| 5% Error + Quality Assurance Costs (5%) | \$0.11 |
| Overhead Cost (\$20 per direct labor hour) | \$0.94 |
| Total Cost | \$2.10 |

Table 1: Estimated cost breakdown

Assuming similar manufacturing techniques of our prototype manufacturing, the total manual and labor cost includes:

- Manual heat welding
- Using adhesive to bond filter to plastic

Costs are and can be further reduced from:

- Using existing and/or non-specialized machinery
- Automating welding process
- Eliminating adhesive and use an overmolding process

Acknowledgements

We would like to thank Jordan Kunz, Julia Teitelbaum, Nathan Oh, Paulette Irwin, and others for participating in our user studies and providing us with invaluable feedback. We would also like to thank Dr. Theresa Dankovich for working with us and letting us use the filter paper she developed. Last but not least, we would like to thank Dr. Conrad Zapanta and Krista Rochussen for guiding us through this project.

Current Options

PUR Packets by Proctor & Gamble

- In use in low-resource environments.
- Each packet can purify up to 10 liters of water
- Requires multiple steps, specified waiting times, and equipment

References

[1] http://www.who.int/water_sanitation_health/diseases/en/